

## Installation Information

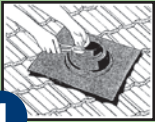

1

Trim the cone to suit pipe size using sharp tin snips.



2

Slide down pipe using water as a lubricant.

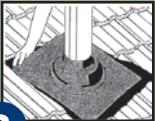

3

Flatten the Dekform sheet and then place upper edge of base underneath the tiles to form a return edge.

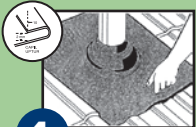

4

Hand dress the apron for a professional finish with a perform hammer.

5

Lift sheet and apply spot adhesion technique using Z Bond Metal & Masonry Silicone V4.

## EASY SELECTION GUIDE

Code No	Pipe External	Pipe External	Sheet Size	Sheet Size	
DFM100GB	0-35mm	0 - 1¾"	410mm X 490mm	16 x 19"	} Black EPDM and Grey Base
DFM101GB	12-70mm	½ - 2¾"	410mm x 490mm	16 x 19"	
DFM102GB	50-170mm	2 - 2¾"	600mm x 450mm	24 x 18"	
DFM103GB	50-170mm	2 - 6¼"	600mm x 450mm	24 x 18"	
DFM108GB	175-330mm	7 - 13"	850mm x 550mm	34 X 22"	

Code No	Pipe External	Pipe External	Sheet Size	Sheet Size	
DFM200GR	0-35mm	0 - 1¾"	410mm X 490mm	16 x 19"	} Red Silicone
DFM201GR	12-70mm	½ - 2¾"	410mm x 490mm	16 x 19"	
DFM203GR	50-170mm	2 - 6¼"	600mm x 450mm	24 x 18"	

### Available in Black and Grey EPDM or Red Silicone

EPDM will withstand constant temperatures at the roofline of -50°C (-122°F) to 115°C (239°F) & up to 150°C (302°F) intermittently.

Red Silicone will withstand constant temperatures at the roofline of -50°C (-112°F) to 200°C (392°F) & up to 250°C (482°F) intermittently.

For higher temperatures always use the Dektite® Silicone range  
Go to [www.deks.com.au](http://www.deks.com.au) for more information on the full range.

## IMPORTANT WHEN INSTALLING

- Use PERFORM hammer to dress down leading edges.
- When installing Dekform we recommend ZBOND Metal & Masonry silicone V4 for adhesion.
- If painting is required, we recommend 100% Acrylic Low Sheen exterior paint for the Perform base.
- If painting is required for the Dektite the surface needs to be weathered for 3 weeks in its installed position then washed with warm water and prepared by coating with a small amount of mild solvent. Then apply 100% Acrylic Low Sheen exterior paint.